



Rough Openings For Commercial Door Frames

Timely 20 GA. Steel Frames:

Recommended Width required: Nominal Door width + 1-1/4"

Recommended Height required: Nominal Door height +1"

16 GA. Steel Drywall Frames 3pc Knockdown (KD):

Recommended Width required: Nominal Door width + 1-1/2"

Recommended Height required: Nominal Door height +3/4"

16 GA. Steel Masonry Frames 3pc Knockdown (KD):

Recommended Width required: Nominal Door width + 4"

Recommended Height required: Nominal Door height + 2"

Commercial Exit Device/Panic Usage Chart

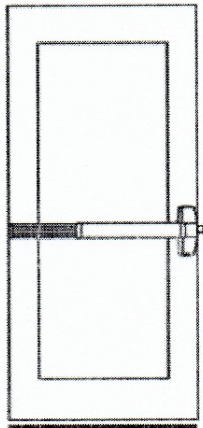
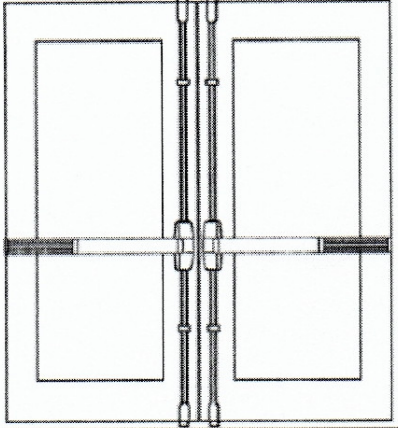
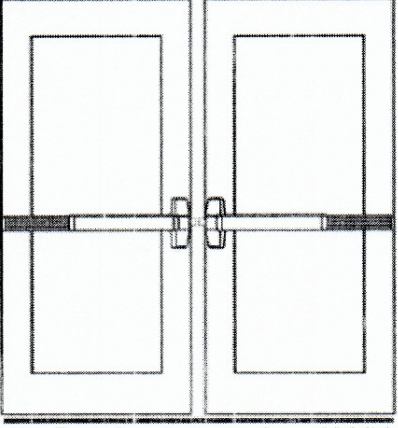
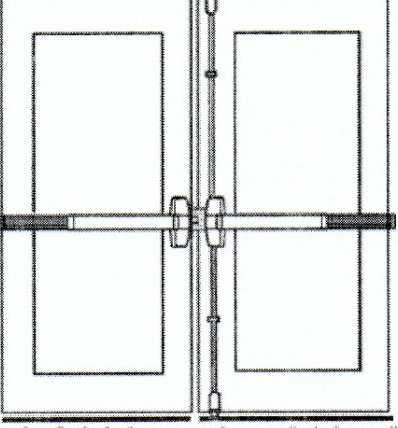
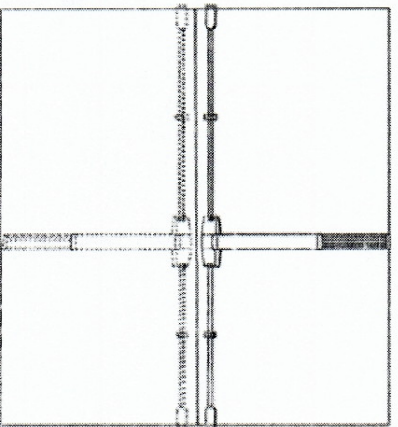
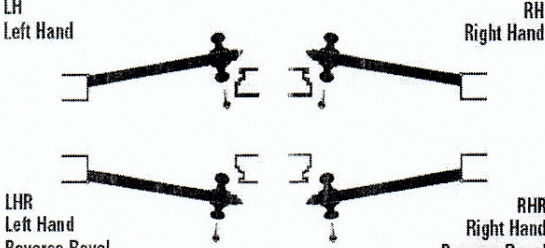
<p style="text-align: center;">SINGLE DOOR</p>  <p>Vertical rod type or Rim type Surface applied 2 point lock. Surface application.</p>	<p style="text-align: center;">PAIR OF DOORS WITHOUT MULLION</p>  <p>2 Vertical rod type Surface applied 2 point locking both doors. Each door active same direction. Do not use with overlapping astragal.</p>
<p style="text-align: center;">PAIR OF DOORS WITH MULLION</p>  <p>2 Rim type with mullion Two independent active doors with full double door openings when required. Same direction.</p>	<p style="text-align: center;">PAIR OF DOORS WITHOUT MULLION</p>  <p>1 Vertical rod and 1 rim type Both devices are surface applied. A coordinator and overlapping strike is recommended.</p>
<p style="text-align: center;">PAIR OF DOORS WITHOUT MULLION</p>  <p>2 Vertical rod type Double egress surface applied. 2 point locking both doors opposite directions.</p>	<div data-bbox="837 1444 1417 1736">  <p>LH Left Hand RH Right Hand</p> <p>LHR Left Hand Reverse Bevel RHR Right Hand Reverse Bevel</p> </div>

Standard Commercial Drywall Frame Applications and Installation

Standard Commercial Drywall frames consist of a 3 piece knock down construction with a base strap anchor and compression anchors as shown below.

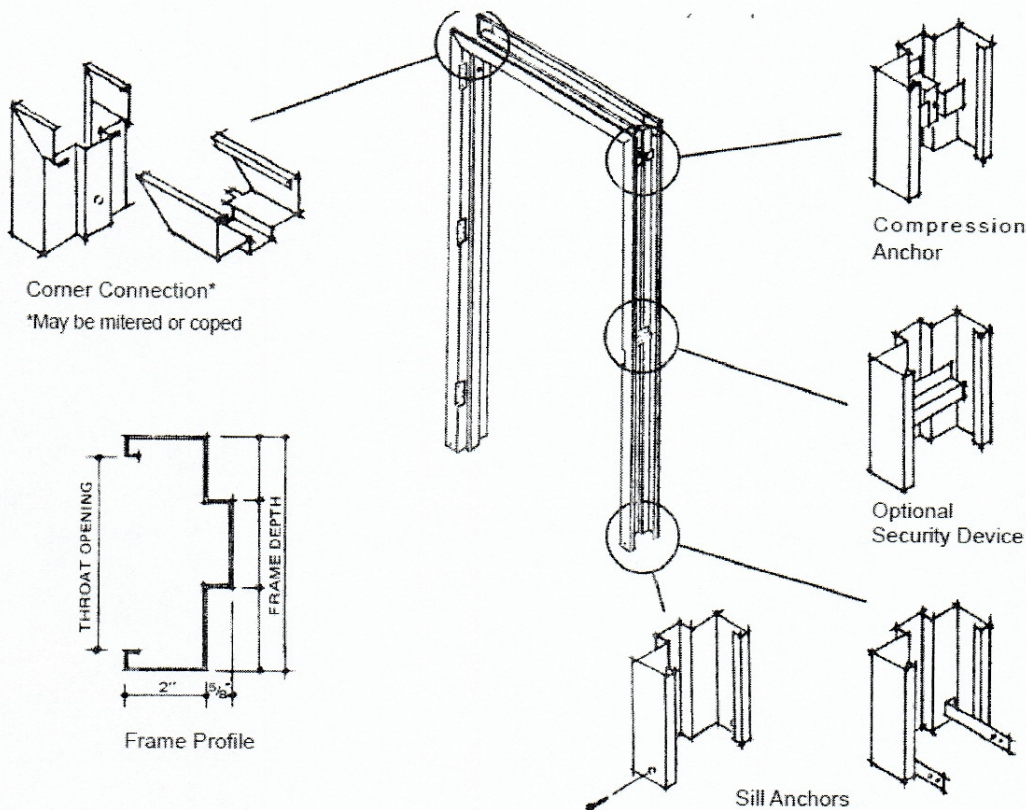

Commercial Drywall frames are meant to wrap a finished wall and can be used in almost any stud wall application where a wrap around type frame is approved.

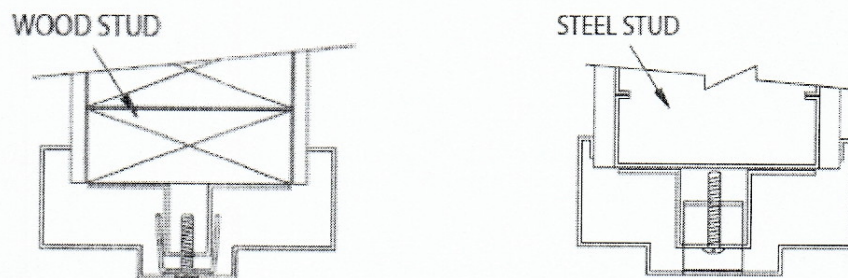

Commercial Drywall Frames are quick and easy to install. The Diagram below illustrates how the frame is installed into an existing opening.

Masonry Frame Applications for New Construction

Frame applications in new construction or unfinished masonry wall openings commonly use a floor base anchor to secure the frame to the floor with a field approved mechanical fastener. The Floor Base anchor is welded to the bottom of the masonry frame.

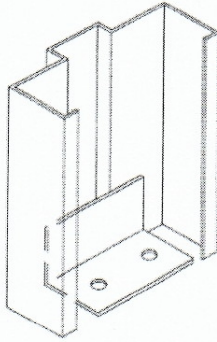

Floor Base Anchor

In addition to the floor base anchor the frame must also be mounted by using a masonry strap anchor or a masonry wire anchor as shown below.

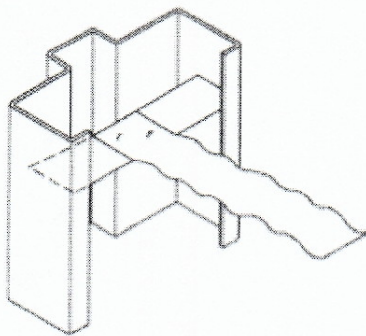

Masonry Strap Anchor

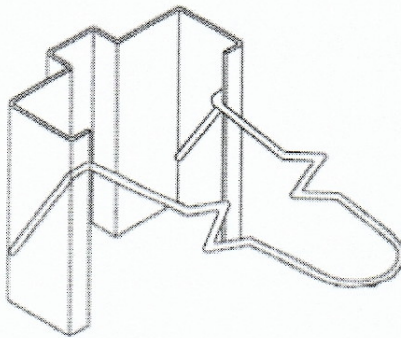

Masonry Wire Anchor

These anchors are not welded to the frame but mount loose inside the frame and are placed between the blocks during the construction of a masonry wall as shown below. Professional installation is recommended.

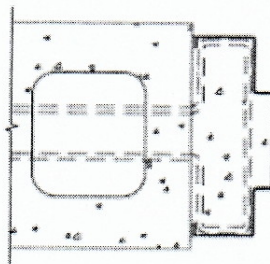

Masonry Wire and Strap Anchor Installation

Masonry Frame Applications for Existing Openings “Punch & Dimple”

Punch and Dimple Prep consists of a welded tube anchors and channel reinforcements for installing steel frames into existing openings where a butt up type frame is required. Punch and dimple prep is recommended for quick and easy installation into any masonry or butt up application.

Punch and dimple prep is commonly used to mount the frame to an existing wall using an expansion bolt or a wood lag bolt as shown below.

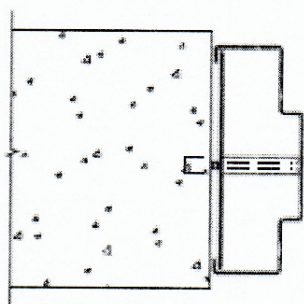

Existing Masonry Wall

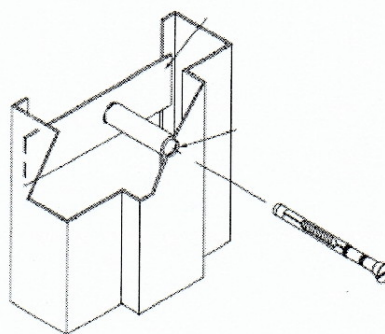

Masonry Expansion Bolt or Wood Lag Bolt Application

Although punch and dimple prep can only be applied to a masonry profile frame, it may be used on a wood framed wall where a butt up frame installation is suitable. Punch and dimple consists of (4) welded tube anchors per leg to reinforce the frame against the insertion of a masonry expansion bolt or wood lag bolt.

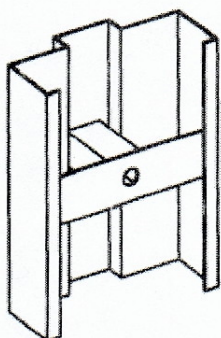

Welded Tube Anchor

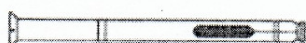

Masonry Expansion Bolt



Wood Lag Bolt